

# State Chinden Campus

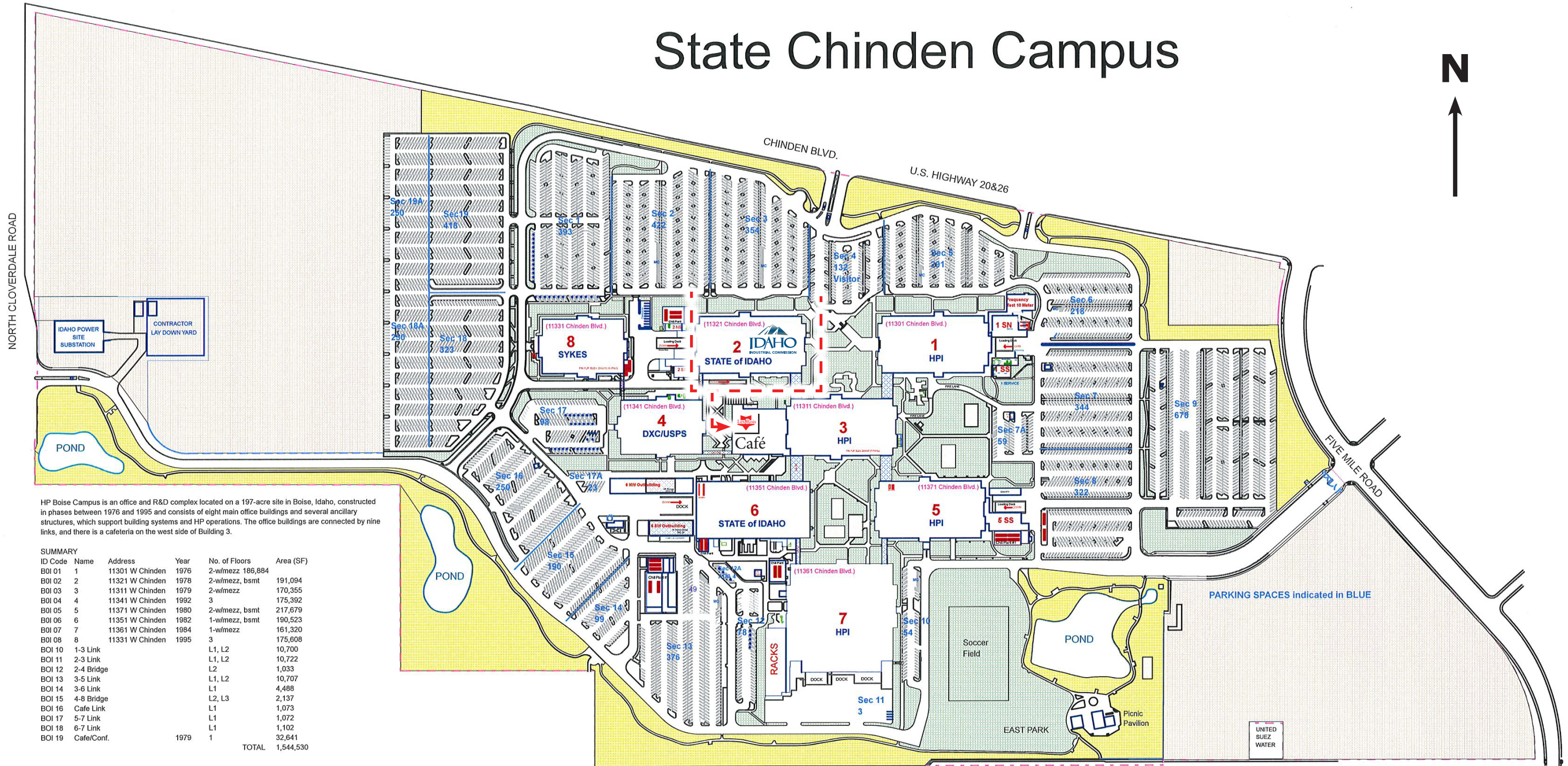

HP Boise Campus is an office and R&D complex located on a 197-acre site in Boise, Idaho, constructed in phases between 1976 and 1995 and consists of eight main office buildings and several ancillary structures, which support building systems and HP operations. The office buildings are connected by nine links, and there is a cafeteria on the west side of Building 3.

**SUMMARY**

ID Code	Name	Address	Year	No. of Floors	Area (SF)
BOI 01	1	11301 W Chinden	1976	2-w/mezz	186,884
BOI 02	2	11321 W Chinden	1978	2-w/mezz, bsmt	191,094
BOI 03	3	11311 W Chinden	1979	2-w/mezz	170,355
BOI 04	4	11341 W Chinden	1992	3	175,392
BOI 05	5	11371 W Chinden	1990	2-w/mezz, bsmt	217,679
BOI 06	6	11351 W Chinden	1982	1-w/mezz, bsmt	190,523
BOI 07	7	11361 W Chinden	1984	1-w/mezz	161,320
BOI 08	8	11331 W Chinden	1995	3	175,608
BOI 10	1-3 Link			L1, L2	10,700
BOI 11	2-3 Link			L1, L2	10,722
BOI 12	2-4 Bridge			L2	1,033
BOI 13	3-5 Link			L1, L2	10,707
BOI 14	3-6 Link			L1	4,488
BOI 15	4-8 Bridge			L2, L3	2,137
BOI 16	Cafe Link			L1	1,073
BOI 17	5-7 Link			L1	1,072
BOI 18	6-7 Link			L1	1,102
BOI 19	Cafe/Conf.		1979	1	32,641
<b>TOTAL</b>					<b>1,544,530</b>

PARKING SPACES indicated in BLUE

UNITED SUEZ WATER